

LT 110 TB38 5

Remote Sensors

Standard, Remote Photoelectric Systems

Compatible Receivers:

LR 110 TB38 5



Product Data	
Function:	Transmitter
Housing Material:	Nickel Plated Brass
Housing:	M12 x 1
Connection:	5 m cable
Sensing Range:	Up to 40 m
Optical Angle:	+/- 5° (emission)
Indicators:	None

Technical Data	
Photo Transistor:	-
Power On Indicator:	-
Output Indicator:	-
Light Source:	Infrared
Cable:	2 x 0,25 mm²
Housing Material Sensor Housing:	Nickel Plated Brass
Housing Material Lens Cover:	Polycarbonate
Transmitter Diode:	Ga Al As, (880 nm)
Cable Sleeve:	PVC Ø 4,0 mm
Min. Cable Bending Radius:	45 mm

Environmental Data	
Vibration:	10 – 55 Hz, 0,5 mm
Shock:	30 g
Operation Temperature:	– 25 to +65 °C
Storage Temperature:	– 40 to +80 °C
Sealing Class:	IP 67
Light Immunity 20°:	> 100 000 lux

Approvals



Wiring Diagram

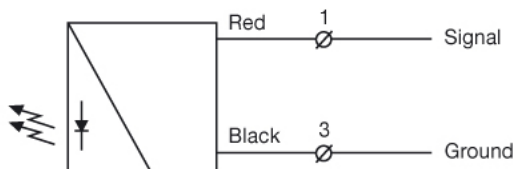

Dimensions

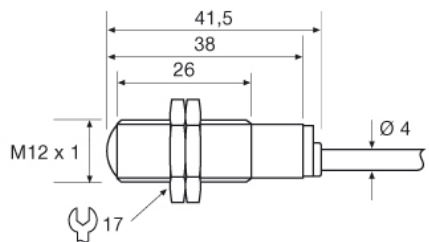

Sensing Characteristics

Parallel Displacement

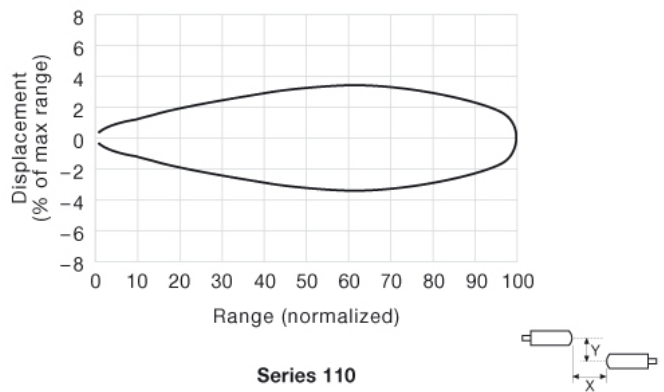

Angular Displacement

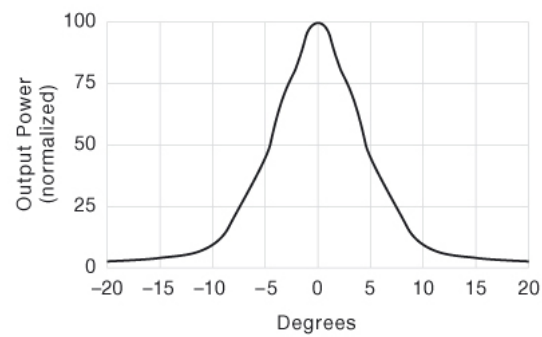

LT 110