

## ■ Installation and Application

1. Before installing, be sure the valve hasn't been damaged via transportation.
2. It's suggested to use the medium lubricated by 40  $\mu$  m filter element. Be aware of the flow direction and port size.
3. Please notice whether the installation condition accords with technical requirements (such as "voltage", "actuation frequency", "working pressure" and "scope of application temperature"), then the equipment can be installed and used.
4. Notice the flow direction of air during installation, P is the air intake, A (B) is the work port and R (S) is the exhaust outlet.
5. Take measure to avoid vibration and frozen.
6. Before using the fittings and tubes make sure they are clean. When connecting to fittings, be sure the PTFE Thread Seal Tape is used correctly.
7. To keep the dust away, please use the silencer for the exhaust ports. Never forget to install dirt-proof boot in air intake and outlet during dismounting.
8. After installing, please use the manual override to test valve first.

# Solenoid valve(3/2 way)

## 3V2M Series

**AIRTAC**



### Symbol

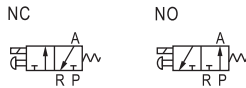

### Product feature

1. Direct acting type and normally closed mode, flexible in direction change.
2. Normally closed and normally open types are optional.
3. Structure in coaxial blanking mode: leakage proof and large air flow.
4. No need to add oil for lubrication.
5. Affiliated manual devices are equipped to facilitate installation and debugging.
6. Valve needs to be used with the sub-base and allows various connection combinations to save space.
7. It is easy to examine when there are faults owing to the unified air intake and exhaust and unified wiring.
8. Flexible combination and strong expansion capability can make any combination or expansion of the numbers of direction control valves that are connected.
9. Can adjust the installation direction of special sub-base seal for NO or NC functions.

### Flow chart

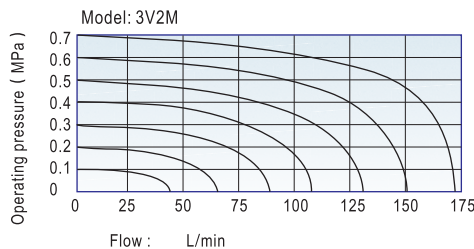

### Inner structure

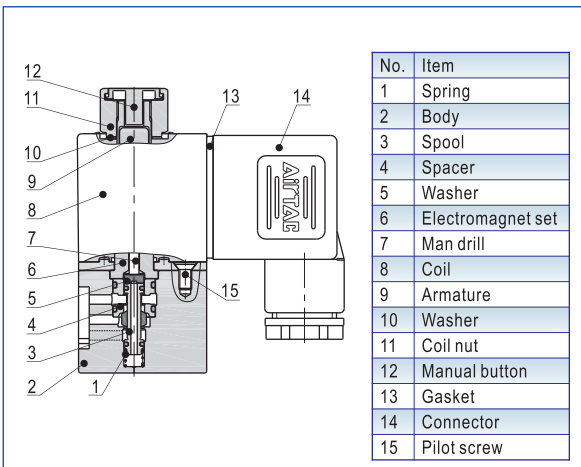

### Specification

Model	3V2M
Fluid	Air(to be filtered by 40 μ m filter element)
Acting	Direct acting
Port size ①	1/8"
Valve type	3 port 2 position
Orifice size	1.7mm <sup>2</sup> (Cv=0.1)
Exhaust type	Centralized exhaust, Separated exhaust
Operating pressure	0~0.8MPa(0~114psi)
Proof pressure	1.5MPa(215psi)
Temperature ℃	-20~70
Material of body	Aluminum alloy

① PT thread, G thread and NPT thread are available.

### Coil specification

Item	Specification
Standard voltage	AC220V, AC110V, AC24V, DC24V, DC12V
Scope of voltage	AC: ± 15% DC: ± 10%
Power consumption	AC:7VA DC:7.0W
Protection	IP65(DIN40050)
Temperature classification	B Class
Electrical entry	Terminal, Grommet
Activating time	0.05 sec and below
Max. frequency ①	10 cycle/sec

① The maximum actuation frequency is in the no-load state.

### Ordering code

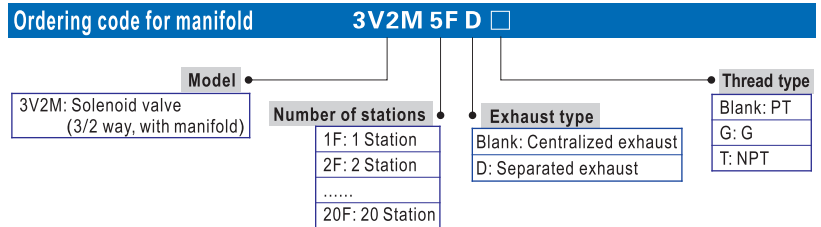
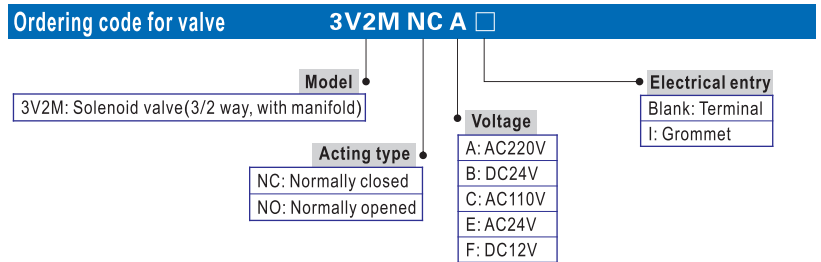

Note: Manifold kits contains manifold, seal and screw. The port size is only 1/8".

### Ordering code for blank plate P-3V2M R2

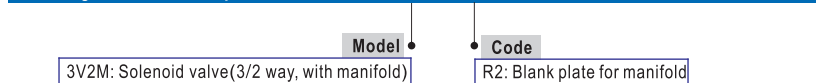

Note: Blank plate kits contains blank plate and screw.

### Ordering code for valve's group(valve+manifold) 3V2M NC A -D 5F

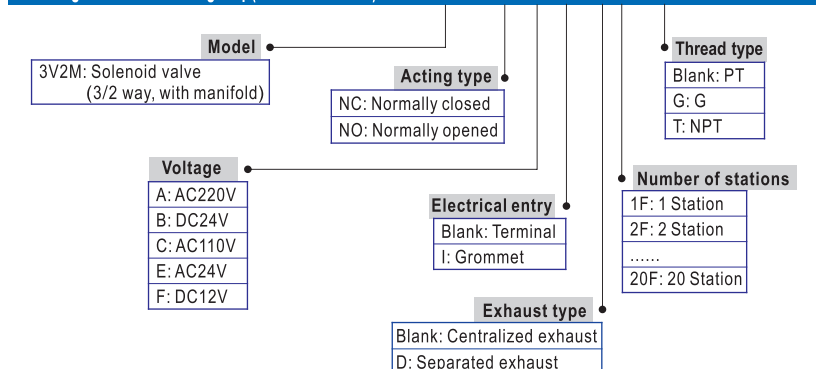

## 3V2M Series

## Valve(Terminal)

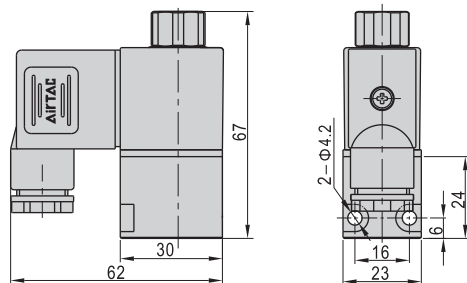

### Valve(Grommet)

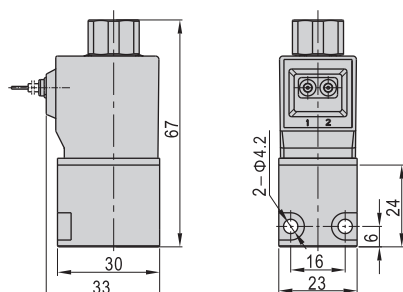

Valve's group(Terminal, Centralized exhaust)

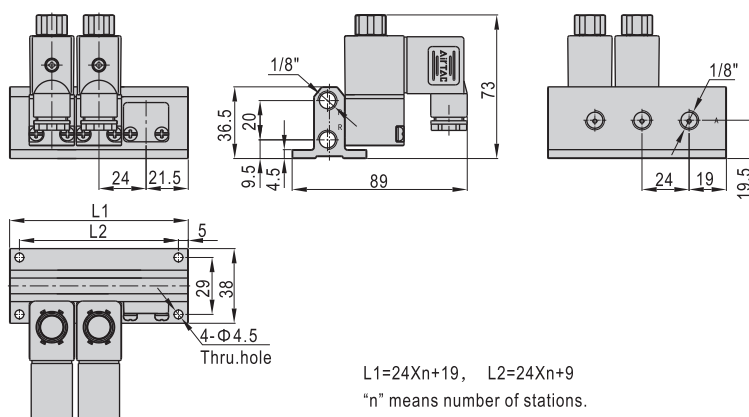

$L1=24Xn+19$ ,  $L2=24Xn+9$   
 "n" means number of stations.

**Valve's group(Terminal, Separated exhaust)**

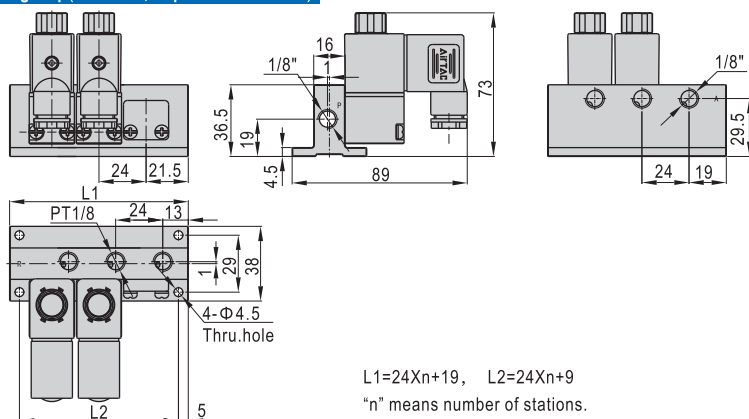

$L1=24Xn+19$ ,  $L2=24Xn+9$   
 "n" means number of stations.

**Valve's group(Grommet, Centralized exhaust)**

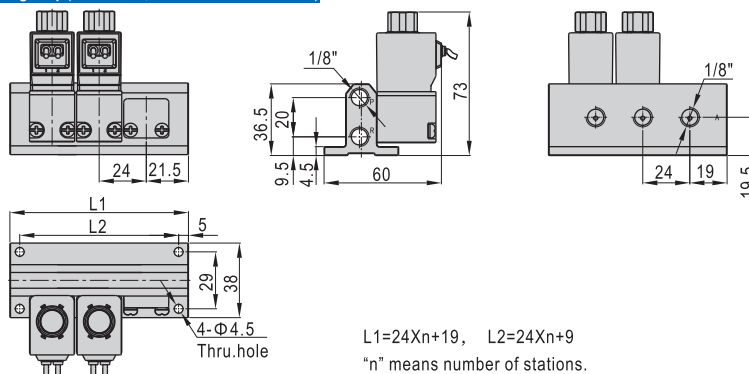

$L1=24Xn+19$ ,  $L2=24Xn+9$   
 "n" means number of stations.

### Valve's group(Grommet, Separated exhaust)

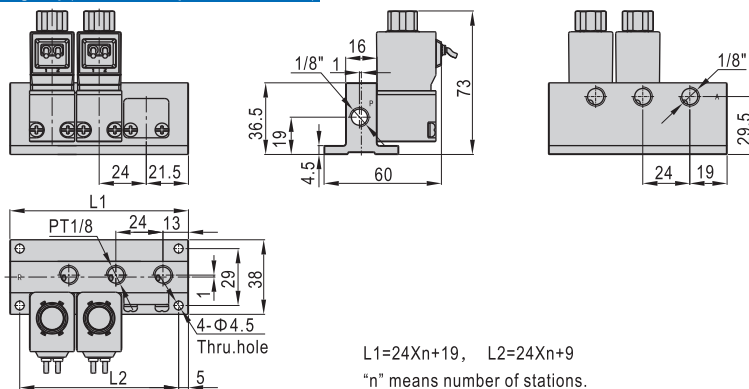

$L1=24Xn+19$ ,  $L2=24Xn+9$   
 "n" means number of stations.